

**FOR INFORMATION ONLY:
DO NOT MANUFACTURE
PARTS TO THIS DRAWING**

- NOTES:
- 1. SUBSTRATE
UV GRADE FUSED SILICA
 - 2. SURFACE S2 TO BE PARALLEL WITH SURFACE S1 TO WITHIN 5 ARCSEC
 - 3. COATING (APPLY ACROSS COATING APERTURE)

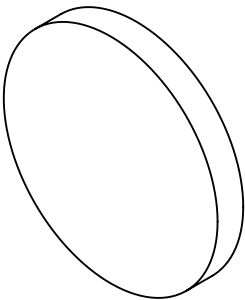

PERFORMANCE SPECIFICATIONS @ 0° AOI
T(AVG): >85% FROM 1010 - 2000nm
T(AVG): < 1% FROM 735 - 925nm
T(ABS): = 50% @ 975nm

S1: MULTILAYER DIELECTRIC COATING
S2: SINGLE LAYER MgF2

4. FINE GRIND SURFACE
5. TRANSMITTED WAVEFRONT DISTORTION RMS@ 632.8nm ≤ ¼ WAVE
6. ROHS COMPLIANT

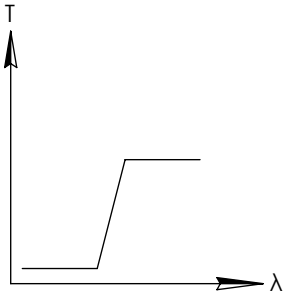
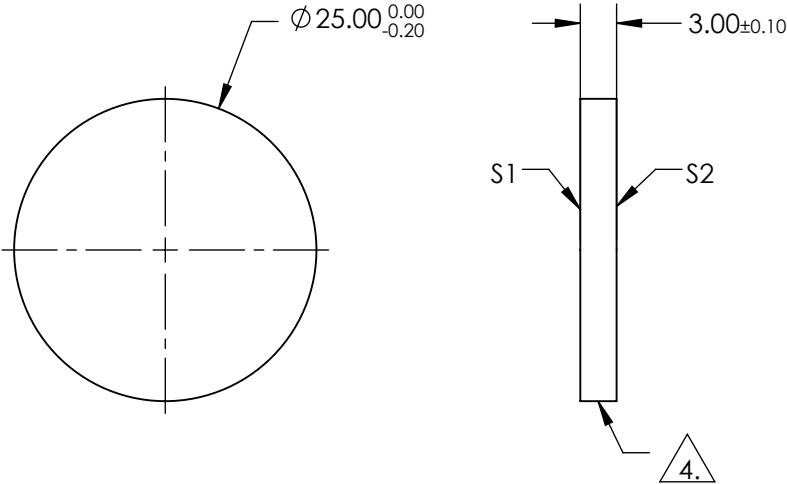

LONGPASS FILTER

SPECIFICATIONS SUBJECT TO CHANGE WITHOUT NOTICE
DIMENSIONS ARE FOR REFERENCE ONLY

| | S1 | S2 |
|------------------|----------------------|----------------------|
| SHAPE | PLANO | PLANO |
| SURFACE QUALITY | 40-20 | 40-20 |
| CLEAR APERTURE | 80% | 80% |
| COATING APERTURE | Ø20.00 | Ø20.00 |
| BEVEL | PROTECTIVE AS NEEDED | PROTECTIVE AS NEEDED |

Edmund Optics®



ALL DIMS IN

mm

TITLE

OD2, Ø25mm, 975nm LONGPASS FILTER

DWG NO

64686

SHEET
1 OF 1