

NOTES:

1. SUBSTRATE
2. SURFACE S2 TO BE PARALLEL WITH SURFACE S1 TO WITHIN 5 arcsec
3. COATING (APPLY ACROSS COATING APERTURE)
ENVIRONMENTAL DURABILITY:
PHYSICAL DURABILITY:
PERFORMANCE SPECIFICATIONS:
T(avg): >85% FROM 625 - 1600nm FOR RANDOM POLARIZATION @ 45° AOI
T(abs): >80% FROM 625 - 1600nm FOR ALL POLARIZATIONS @ 45° AOI
R(avg): >97% FROM 460 - 570nm FOR RANDOM POLARIZATION @ 45° AOI
R(abs): >95% FROM 460 - 570nm FOR ALL POLARIZATIONS @ 45° AOI
T(abs): = 50% 600nm @ 45° AOI

4. FINE GRIND SURFACE

5. POWER, IRREGULARITY, AND SURFACE QUALITY SPECIFICATIONS
APPLY ACROSS CLEAR APERTURE
6. TRANSMITTED WAVEFRONT DISTORTION RMS@ 632.8nm $\leq \frac{1}{4} \lambda$
7. ROHS COMPLIANT

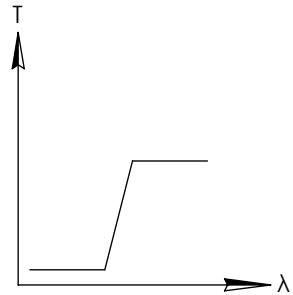

LONGPASS FILTER

**FOR INFORMATION ONLY:
DO NOT MANUFACTURE
PARTS TO THIS DRAWING**

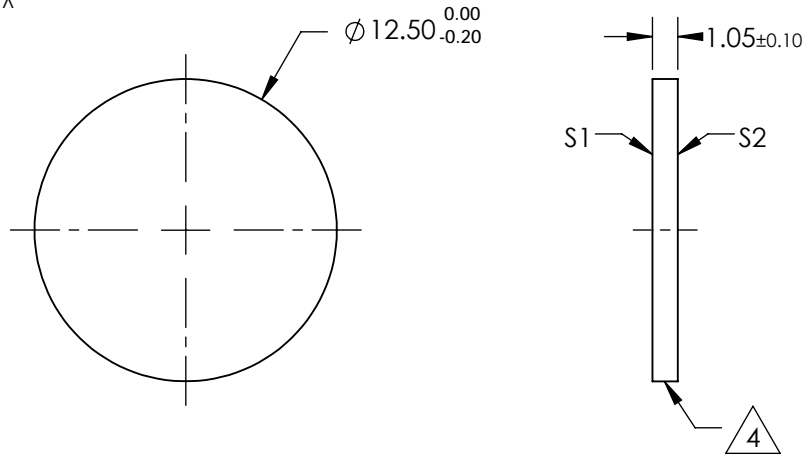
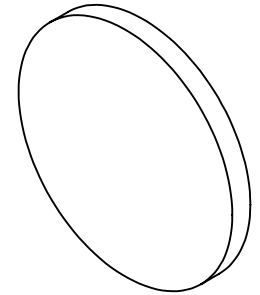

SPECIFICATIONS SUBJECT TO CHANGE WITHOUT NOTICE
DIMENSIONS ARE FOR REFERENCE ONLY

	S1	S2
SHAPE	PLANO	PLANO
SURFACE QUALITY	60-40	60-40
CLEAR APERTURE	Ø11.00	Ø11.00
COATING APERTURE	Ø11.00	Ø11.00
BEVEL	PROTECTIVE AS NEEDED	PROTECTIVE AS NEEDED

THIRD ANGLE PROJECTION			
TITLE		Ø12.5mm, 600nm DICHROIC LONGPASS FILTER	
ALL DIMS IN	mm	DWG NO	69868
			SHEET 1 OF 1