

NOTES:

1. SUBSTRATE:
GRADE A FINE ANNEALED
- ② COATING (APPLY ACROSS COATING APERTURE)
 $R(AVG) \leq 0.5\%$ FROM 600-1050nm @ 0° AOI
3. CENTERING TOLERANCE (AT 587.6nm):
PLANO AXIS WEDGE: < 5 ARCMIN
POWER AXIS WEDGE: < 5 ARCMIN
AXIAL TWIST: < 3 ARCMIN
- △ 4. FINE GRIND SURFACE
5. POWER, IRREGULARITY, AND SURFACE QUALITY
SPECIFICATIONS APPLY ACROSS CLEAR APERTURE
6. FOCAL LENGHT (EFL): 50nm
BACK FOCAL LENGTH (BFL): 47.14nm
7. RoHS COMPLIANT

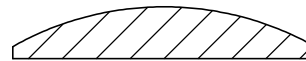
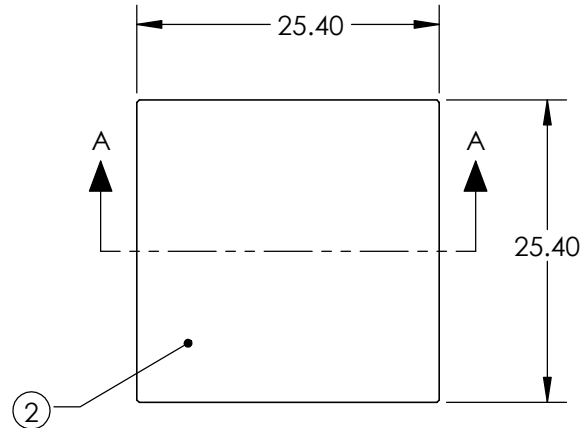
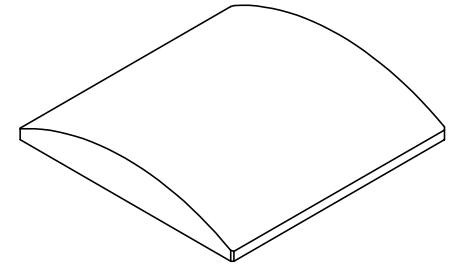

SECTION A-A

**FOR INFORMATION ONLY:
DO NOT MANUFACTURE
PARTS TO THIS DRAWING**

SPECIFICATIONS SUBJECT TO CHANGE WITHOUT NOTICE
DIMENSIONS ARE FOR REFERENCE ONLY



	S1	S2
SHAPE	CONVEX	PLANO
SURFACE QUALITY	40 - 20	40 - 20
CLEAR APERTURE	Ø22.86 x 22.86	Ø22.86 x 22.86
BEVEL	PROTECTIVE AS NEEDED	PROTECTIVE AS NEEDED



ALL DIMS IN mm

TITLE	LENS PCX CYL, 25.4 SQ x 50 EFL NIR I		
DWG NO	35000	SHEET 1 OF 1	