

NOTES:

1. SUBSTRATE
- FUSED SILICA
2. SURFACE S2 TO BE PARALLEL WITH S1 WITHIN < 3 ARCMIN
3. COATING (APPLY ACROSS CLEAR APERTURE)
- S1: ND:YAG LASER
- R(abs) >99.5% @ 266nm @ 0° AOI
- R(avg) >98% @ 255 - 275nm @ 0° AOI
- DAMAGE THRESHOLD: 3 J/cm² @ 10ns
- S2: NONE
4. FINE GROUND SURFACE
5. POWER, IRREGULARITY, SURFACE QUALITY, AND COATING SPECIFICATIONS APPLY ACROSS CLEAR APERTURE
6. RoHS COMPLIANT

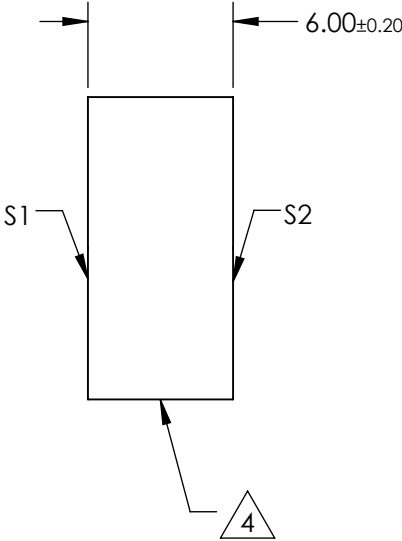
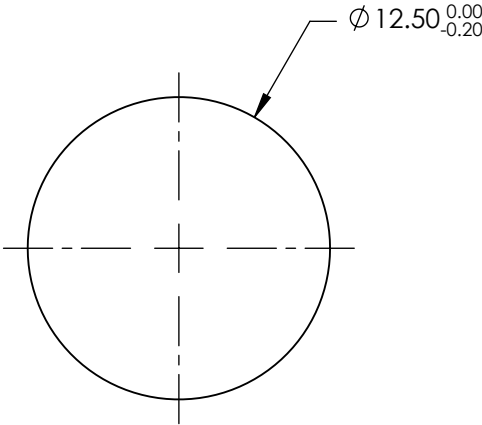

FOR INFORMATION ONLY:  
DO NOT MANUFACTURE  
PARTS TO THIS DRAWING

SPECIFICATIONS SUBJECT TO CHANGE WITHOUT NOTICE  
DIMENSIONS ARE FOR REFERENCE ONLY

REV. A	S1	S2
SHAPE	PLANO	PLANO
SURFACE FLATNESS	$\lambda/10$	N/A
SURFACE QUALITY	10 - 5	FINE GROUND
CLEAR APERTURE	Ø11.25	N/A
BEVEL	PROTECTIVE AS NEEDED	PROTECTIVE AS NEEDED

THIRD ANGLE  
PROJECTION

TITLE

Ø12.5mm, 266nm, 0°, ND:YAG LASER LINE MIRROR

DWG NO

63110

SHEET

1 OF 1