

NOTES:

1. SUBSTRATE MATERIAL:  
BOROFLOAT®

2. COATING (APPLY ACROSS CLEAR APERTURE)

S1: Enhanced Aluminum  
R(avg) >95% @ 450 - 650nm  
DENSITY LIMIT: 0.2 J/cm<sup>2</sup> @ 532nm, 10ns  
S2: NONE

3. POWER, IRREGULARITY, SURFACE QUALITY, AND COATING SPECIFICATIONS APPLY ACROSS CLEAR APERTURE

△ 4. FINE GROUND SURFACE

5. ROHS COMPLIANT

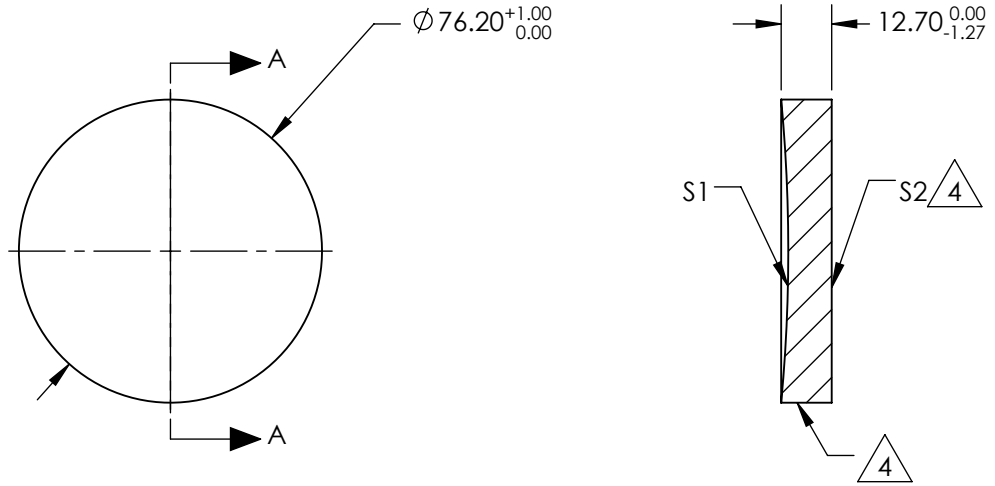

SECTION A-A

**FOR INFORMATION ONLY:  
DO NOT MANUFACTURE  
PARTS TO THIS DRAWING**

SPECIFICATIONS SUBJECT TO CHANGE WITHOUT NOTICE  
DIMENSIONS ARE FOR REFERENCE ONLY

REV. A	S1	S2
SHAPE	CONCAVE	PLANO
EFFECTIVE FOCAL LENGTH	203.2mm	N/A
FOCAL LENGTH TOLERANCE	±2%	N/A
APERTURE	f/2.7	N/A
SURFACE QUALITY	60-40	60-40
SURFACE FLATNESS	λ/4	λ/4
BEVEL	PROTECTIVE AS NEEDED	PROTECTIVE AS NEEDED

THIRD ANGLE  
PROJECTION

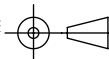

ALL DIMS IN

mm

**EO**® **Edmund Optics**®

TITLE

∅3in, 8in FL ENHANCED ALIUMINUM,  
SPHERICAL MIRRORS

DWG NO

43585

SHEET  
1 OF 1