

FOCAL LENGTH (EFL): $75 \pm 0,75$
 BACK FOCAL LENGTH (BFL): $73,35$

1 AR COATING: NONE

LEFT SURFACE		MATERIAL	RIGHT SURFACE	
R	$76,67 \pm 0,077$ CX	GLASS N-BK7 517/642	R	$76,67 \pm 0,077$ CX
Øe	29		Øe	29
3/	3 (0,5) $\lambda=632,8$ nm		3/	3 (0,5) $\lambda=632,8$ nm
4/	-		4/	1,93'
5/	40 - 20 (MIL-PRF-13830B)		5/	40 - 20 (MIL-PRF-13830B)
6/	-		6/	-

PROTECTIVE CHAMFERS AS NEEDED

ROHS: COMPLIANT SCALE: NONE $\lambda = 587,6$ nm

SPECIFICATIONS SUBJECT TO CHANGE WITHOUT NOTICE. DIMENSIONS ARE FOR REFERENCE ONLY

FOR INFORMATION ONLY: DO NOT MANUFACTURE PARTS TO THIS DRAWING

INDICATIONS IN ACCORDANCE WITH ISO 10110

FIRST ANGLE PROJECTION

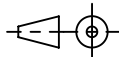

ALL DIMS IN: mm

EO® Edmund Optics®

TITLE 30mm Dia, x 75mm FL Uncoated, Double-Convex Lens

DWG NO 45165

SHEET SIZE A4

SHEET 1 OF 1