

FOCAL LENGTH (EFL): $-9 \pm 0,09$
 BACK FOCAL LENGTH (BFL): $-9,56$

1 AR COATING:

$\frac{1}{4}$ WAVE MgF₂ @ 550nm
 R(AVG) < 1,75% FROM 400-700nm (N-BK7)

LEFT SURFACE		MATERIAL	RIGHT SURFACE	
R	7,06±0,007 CV	GLASS N-SF11 785/258	R	∞ PL
Øe	2,5		Øe	2,5
3/	3 (0,5) λ=632,8 nm		3/	3 (0,5) λ=632,8 nm
4/	-		4/	3,82'
5/	20 - 10 (MIL-PRF-13830B)		5/	20 - 10 (MIL-PRF-13830B)
6/	-		6/	-

PROTECTIVE CHAMFERS AS NEEDED

ROHS: COMPLIANT
 SCALE: NONE
 λ = 587,6nm

SPECIFICATIONS SUBJECT TO CHANGE WITHOUT NOTICE. DIMENSIONS ARE FOR REFERENCE ONLY

FOR INFORMATION ONLY: DO NOT MANUFACTURE PARTS TO THIS DRAWING

INDICATIONS IN ACCORDANCE WITH ISO 10110

FIRST ANGLE PROJECTION

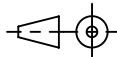

ALL DIMS IN: mm

EO® Edmund Optics®

TITLE

3,0mm Diameter x -9 FL, MgF₂ Coated, Plano-Concave Lens

DWG NO

45375

SHEET SIZE
A4

SHEET
1 OF 1