

FOCAL LENGTH (EFL): $12 \pm 0,12$
 BACK FOCAL LENGTH (BFL): 10,83

1 AR COATING:

$\frac{1}{4}$ WAVE MgF2 @ 550nm
 R(AVG) < 1,75% FROM 400-700nm (N-BK7)

LEFT SURFACE		MATERIAL	RIGHT SURFACE	
R	6,22±0,006 CX	GLASS N-BK7 517/642	R	∞ PL
Øe	4,5		Øe	4,5
3/	3 (0,5) $\lambda=632,8$ nm		3/	3 (0,5) $\lambda=632,8$ nm
4/	-		4/	1,93'
5/	40 - 20 (MIL-PRF-13830B)		5/	40 - 20 (MIL-PRF-13830B)
6/	-		6/	-

PROTECTIVE CHAMFERS AS NEEDED

ROHS: COMPLIANT SCALE: NONE $\lambda = 587,6$ nm

SPECIFICATIONS SUBJECT TO CHANGE WITHOUT NOTICE. DIMENSIONS ARE FOR REFERENCE ONLY

FOR INFORMATION ONLY: DO NOT MANUFACTURE PARTS TO THIS DRAWING

INDICATIONS IN ACCORDANCE WITH ISO 10110

FIRST ANGLE PROJECTION

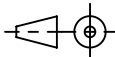

ALL DIMS IN: mm

EO® Edmund Optics®

TITLE 5,0mm Dia, x 12,0mm FL, MgF2 Coated, Plano-Convex Lens

DWG NO 45434

SHEET SIZE A4 SHEET 1 OF 1