

FOCAL LENGTH (EFL):  $-12 \pm 0,12$   
 BACK FOCAL LENGTH (BFL):  $-12,99$

- 1 AR COATING: VIS-NIR  
 $R(\text{ABS}) \leq 0,25\%$  AT 880nm @  $0^\circ$  AOI  
 $R(\text{AVG}) \leq 1,25\%$  FROM 400-870nm @  $0^\circ$  AOI  
 $R(\text{AVG}) \leq 1,25\%$  FROM 890-1000nm @  $0^\circ$  AOI
- 2 BLACKENED SURFACE

LEFT SURFACE		MATERIAL	RIGHT SURFACE	
R	$6,2 \pm 0,006$ CV	GLASS N-BK7 517/642	R	$\infty$ PL
$\text{Øe}$	5,4		$\text{Øe}$	5,4
3/	3 (0,5) $\lambda=632,8$ nm		3/	3 (0,5) $\lambda=632,8$ nm
4/	-		4/	1,93'
5/	40 - 20 (MIL-PRF-13830B)		5/	40 - 20 (MIL-PRF-13830B)
6/	-		6/	-

PROTECTIVE CHAMFERS AS NEEDED

ROHS: COMPLIANT    SCALE: NONE     $\lambda = 587,6$ nm

SPECIFICATIONS SUBJECT TO CHANGE WITHOUT NOTICE. DIMENSIONS ARE FOR REFERENCE ONLY

FOR INFORMATION ONLY: DO NOT MANUFACTURE PARTS TO THIS DRAWING

INDICATIONS IN ACCORDANCE WITH ISO 10110

FIRST ANGLE PROJECTION

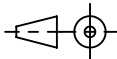

ALL DIMS IN: mm



Edmund Optics®

TITLE 6mm Diameter x -12 FL, VIS-NIR, Inked, Plano-Concave Lens

DWG NO 45911INK

SHEET SIZE A4

SHEET 1 OF 1