

FOCAL LENGTH (EFL): 175 ±1,75
 BACK FOCAL LENGTH (BFL): 173,94

1 AR COATING: VIS 0°
 R(AVG) ≤ 0,4% FROM 425-675nm @ 0° AOI

LEFT SURFACE		MATERIAL	RIGHT SURFACE	
R	180,4±0,18 CX	GLASS N-BK7 517/642	R	180,4±0,18 CX
Øe	24		Øe	24
3/	3 (0,5) λ=632,8 nm		3/	3 (0,5) λ=632,8 nm
4/	-		4/	1,93'
5/	40 - 20 (MIL-PRF-13830B)		5/	40 - 20 (MIL-PRF-13830B)
6/	-		6/	-

PROTECTIVE CHAMFERS AS NEEDED

ROHS: COMPLIANT
 SCALE: NONE λ = 587,6nm

SPECIFICATIONS SUBJECT TO CHANGE WITHOUT NOTICE. DIMENSIONS ARE FOR REFERENCE ONLY

FOR INFORMATION ONLY: DO NOT MANUFACTURE PARTS TO THIS DRAWING

INDICATIONS IN ACCORDANCE WITH ISO 10110

FIRST ANGLE PROJECTION

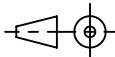

ALL DIMS IN: mm



Edmund Optics®

TITLE 25mm Dia, x 175mm FL, VIS 0 Coated, Double-Convex Lens

DWG NO 47373

SHEET SIZE A4 SHEET 1 OF 1