

FOCAL LENGTH (EFL): $60 \pm 0,6$

BACK FOCAL LENGTH (BFL): $58,65$

- 1 AR COATING: VIS 0°
R(AVG) $\leq 0,4\%$ FROM 425-675nm @ 0° AOI
- 2 BLACKENED SURFACE

LEFT SURFACE		MATERIAL	RIGHT SURFACE	
R	$31,11 \pm 0,031$ CX	GLASS N-BK7 517/642	R	∞ PL
$\varnothing e$	14		$\varnothing e$	14
3/	3 (0,5) $\lambda=632,8$ nm		3/	3 (0,5) $\lambda=632,8$ nm
4/	-		4/	1,93'
5/	40 - 20 (MIL-PRF-13830B)		5/	40 - 20 (MIL-PRF-13830B)
6/	-		6/	-

PROTECTIVE CHAMFERS AS NEEDED

ROHS: COMPLIANT SCALE: NONE $\lambda = 587,6$ nm

SPECIFICATIONS SUBJECT TO CHANGE WITHOUT NOTICE. DIMENSIONS ARE FOR REFERENCE ONLY

FOR INFORMATION ONLY: DO NOT MANUFACTURE PARTS TO THIS DRAWING

INDICATIONS IN ACCORDANCE WITH ISO 10110

FIRST ANGLE PROJECTION

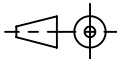

ALL DIMS IN: mm

EO® Edmund Optics®

TITLE 15,0mm Dia, x 60,0mm FL, VIS 0, Inked, Plano-Convex Lens

DWG NO 478761NK

SHEET SIZE A4 SHEET 1 OF 1