

FOCAL LENGTH (EFL): $12 \pm 0,12$
 BACK FOCAL LENGTH (BFL): 9,26

1 AR COATING: VIS 0°
 $R(\text{AVG}) \leq 0,4\%$ FROM 425-675nm @ 0° AOI

LEFT SURFACE		MATERIAL	RIGHT SURFACE	
R	5,5±0,006 CX	GLASS FUSED SILICA 458/678	R	∞ PL
Øe	8,1		Øe	8,1
3/	3 (0,5) $\lambda=632,8$ nm		3/	3 (0,5) $\lambda=632,8$ nm
4/	-		4/	2,18'
5/	40 - 20 (MIL-PRF-13830B)		5/	40 - 20 (MIL-PRF-13830B)
6/	-		6/	-

PROTECTIVE CHAMFERS AS NEEDED

ROHS: COMPLIANT
 SCALE: NONE
 $\lambda = 587,6$ nm

SPECIFICATIONS SUBJECT TO CHANGE WITHOUT NOTICE. DIMENSIONS ARE FOR REFERENCE ONLY

FOR INFORMATION ONLY: DO NOT MANUFACTURE PARTS TO THIS DRAWING

INDICATIONS IN ACCORDANCE WITH ISO 10110

FIRST ANGLE PROJECTION

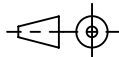

ALL DIMS IN: mm

EO® Edmund Optics®

TITLE 9mm Dia, x 12mm FL VIS 0 Coated, UV Plano-Convex Lens

DWG NO 48949

SHEET SIZE A4
 SHEET 1 OF 1