

FOCAL LENGTH (EFL): $-24 \pm 0,24$
 BACK FOCAL LENGTH (BFL): $-26,32$

- 1 AR COATING: NIR II
 $R(\text{ABS}) \leq 1,5\%$ FROM 750-800nm @ 0° AOI
 $R(\text{ABS}) \leq 1,0\%$ FROM 800-1550nm @ 0° AOI
 $R(\text{AVG}) \leq 0,7\%$ FROM 750-1550nm @ 0° AOI

LEFT SURFACE		MATERIAL	RIGHT SURFACE	
R	12,4±0,012 CV	GLASS N-BK7 517/642	R	∞ PL
Øe	11		Øe	11
3/	3 (0,5) $\lambda=632,8$ nm		3/	3 (0,5) $\lambda=632,8$ nm
4/	-		4/	1,93'
5/	40 - 20 (MIL-PRF-13830B)		5/	40 - 20 (MIL-PRF-13830B)
6/	-		6/	-

PROTECTIVE CHAMFERS AS NEEDED

ROHS: COMPLIANT
 SCALE: NONE
 $\lambda = 587,6\text{nm}$

SPECIFICATIONS SUBJECT TO CHANGE WITHOUT NOTICE. DIMENSIONS ARE FOR REFERENCE ONLY

FOR INFORMATION ONLY: DO NOT MANUFACTURE PARTS TO THIS DRAWING

INDICATIONS IN ACCORDANCE WITH ISO 10110

FIRST ANGLE PROJECTION

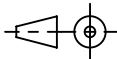

ALL DIMS IN: mm



Edmund Optics®

TITLE

12mm Diameter x -24 FL, NIR II Coated, Plano-Concave Lens

DWG NO

67994

SHEET SIZE
A4

SHEET
1 OF 1