

FOCAL LENGTH (EFL): $-24 \pm 0,24$
 BACK FOCAL LENGTH (BFL): $-24,65$

- 1 AR COATING: NIR II
 $R(\text{ABS}) \leq 1,5\%$ FROM 750-800nm @ 0° AOI
 $R(\text{ABS}) \leq 1,0\%$ FROM 800-1550nm @ 0° AOI
 $R(\text{AVG}) \leq 0,7\%$ FROM 750-1550nm @ 0° AOI

LEFT SURFACE		MATERIAL	RIGHT SURFACE	
R	25,142±0,025 CV	GLASS N-BK7 517/642	R	25,142±0,025 CV
Øe	11		Øe	11
3/	3 (0,5) $\lambda=632,8$ nm		3/	3 (0,5) $\lambda=632,8$ nm
4/	-		4/	1,93'
5/	40 - 20 (MIL-PRF-13830B)		5/	40 - 20 (MIL-PRF-13830B)
6/	-		6/	-

PROTECTIVE CHAMFERS AS NEEDED

ROHS: COMPLIANT SCALE: NONE $\lambda = 587,6\text{nm}$

SPECIFICATIONS SUBJECT TO CHANGE WITHOUT NOTICE. DIMENSIONS ARE FOR REFERENCE ONLY

FOR INFORMATION ONLY: DO NOT MANUFACTURE PARTS TO THIS DRAWING

INDICATIONS IN ACCORDANCE WITH ISO 10110

FIRST ANGLE PROJECTION

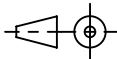

ALL DIMS IN: mm

EO® Edmund Optics®

TITLE 12mm Dia, x -24mm FL, NIR II Coated, Double-Concave Lens

DWG NO 68013

SHEET SIZE A4 SHEET 1 OF 1