

FOCAL LENGTH (EFL): $60 \pm 0,6$
 BACK FOCAL LENGTH (BFL): 55,89

1 AR COATING: NONE

LEFT SURFACE		MATERIAL	RIGHT SURFACE	
R	$27,508 \pm 0,028$ CX	GLASS FUSED SILICA 458/678	R	∞ PL
Øe	29		Øe	29
3/	3 (0,5) $\lambda=632,8$ nm		3/	3 (0,5) $\lambda=632,8$ nm
4/	-		4/	2,18'
5/	40 - 20 (MIL-PRF-13830B)		5/	40 - 20 (MIL-PRF-13830B)
6/	-		6/	-

PROTECTIVE CHAMFERS AS NEEDED

ROHS: COMPLIANT
 SCALE: NONE
 $\lambda = 587,6$ nm

SPECIFICATIONS SUBJECT TO CHANGE WITHOUT NOTICE. DIMENSIONS ARE FOR REFERENCE ONLY

FOR INFORMATION ONLY: DO NOT MANUFACTURE PARTS TO THIS DRAWING

INDICATIONS IN ACCORDANCE WITH ISO 10110

FIRST ANGLE PROJECTION

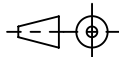

ALL DIMS IN: mm

EO® Edmund Optics®

TITLE 30mm Dia, x 60mm FL Uncoated, UV Plano-Convex Lens

DWG NO 84283

SHEET SIZE A4
 SHEET 1 OF 1