

FOCAL LENGTH (EFL):  $12 \pm 0,12$   
 BACK FOCAL LENGTH (BFL):  $10,63$

1 AR COATING: NONE

LEFT SURFACE		MATERIAL	RIGHT SURFACE	
R	$5,5 \pm 0,006$ CX	GLASS FUSED SILICA 458/678	R	$\infty$ PL
$\varnothing e$	5,4		$\varnothing e$	5,4
3/	2 (0,2) $\lambda=632,8$ nm		3/	2 (0,2) $\lambda=632,8$ nm
4/	-		4/	2,18'
5/	20 - 10 (MIL-PRF-13830B)		5/	20 - 10 (MIL-PRF-13830B)
6/	-		6/	-

PROTECTIVE CHAMFERS AS NEEDED

ROHS: COMPLIANT    SCALE: NONE     $\lambda = 587,6$ nm

SPECIFICATIONS SUBJECT TO CHANGE WITHOUT NOTICE. DIMENSIONS ARE FOR REFERENCE ONLY

FOR INFORMATION ONLY: DO NOT MANUFACTURE PARTS TO THIS DRAWING

INDICATIONS IN ACCORDANCE WITH ISO 10110

FIRST ANGLE PROJECTION

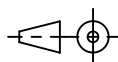

ALL DIMS IN: mm

**EO**® Edmund Optics®

TITLE 6mm Diameter x 12mm FL, Uncoated, Laser Grade PCX Lens

DWG NO 87924

SHEET SIZE A4 SHEET 1 OF 1