

FOCAL LENGTH (EFL): 19,1 ± 0,19

BACK FOCAL LENGTH (BFL): 16,46

- 1 AR COATING: YAG-BBAR
R(ABS) < 0,25% @ 532nm @ 0° AOI
R(ABS) < 0,25% @ 1064nm @ 0° AOI
R(AVG) < 1,0% FROM 500-1100nm @ 0° AOI
- 2 BLACKENED SURFACE

LEFT SURFACE		MATERIAL	RIGHT SURFACE	
R	9,87±0,01 CX	GLASS N-BK7 517/642	R	∞ PL
Øe	11,7		Øe	11,7
3/	3 (0,5) λ=632,8 nm		3/	3 (0,5) λ=632,8 nm
4/	-		4/	1,93'
5/	40 - 20 (MIL-PRF-13830B)		5/	40 - 20 (MIL-PRF-13830B)
6/	-		6/	-

PROTECTIVE CHAMFERS AS NEEDED

ROHS: COMPLIANT SCALE: NONE λ = 587,6nm

SPECIFICATIONS SUBJECT TO CHANGE WITHOUT NOTICE. DIMENSIONS ARE FOR REFERENCE ONLY

FOR INFORMATION ONLY: DO NOT MANUFACTURE PARTS TO THIS DRAWING

INDICATIONS IN ACCORDANCE WITH ISO 10110

FIRST ANGLE PROJECTION

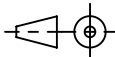

ALL DIMS IN: mm

EO® Edmund Optics®

TITLE 12,7mm Dia, x 19,1mm FL, YAG-BBAR, Inked, Plano-Convex Lens

DWG NO 888461NK

SHEET SIZE A4 SHEET 1 OF 1