

NOTES:

1. SUBSTRATE: ALUMINUM 6061-T6
2. COATING
ULTRAFAST ENHANCED SILVER

R(AVG) > 99% @ 600 - 1000nm
Rs > 99% @ 540 - 1000nm
Rp > 98.5% @ 730 - 870nm
GDD (typical): 0±20fs² @ 600 - 1050nm
3. SURFACE ROUGHNESS: <50 Å RMS
4. SYSTEM SHALL BE ALIGNED TO DATUM **A**
WITH REFLECTED WAVEFRONT ERROR OF ≤ 1/8
WAVE AT 632.8 nm FOR Ø1mm INPUT BEAM.
5. INTEGRATED ALIGNMENT FLATS
6. OPTICAL CENTER LINE
7. RoHS COMPLIANT

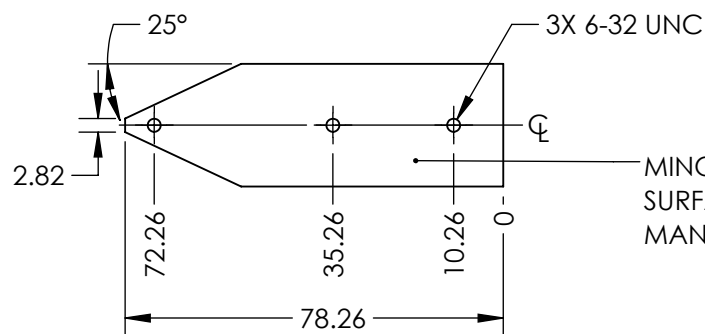
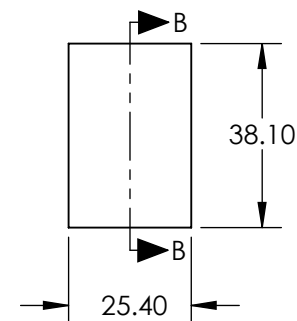
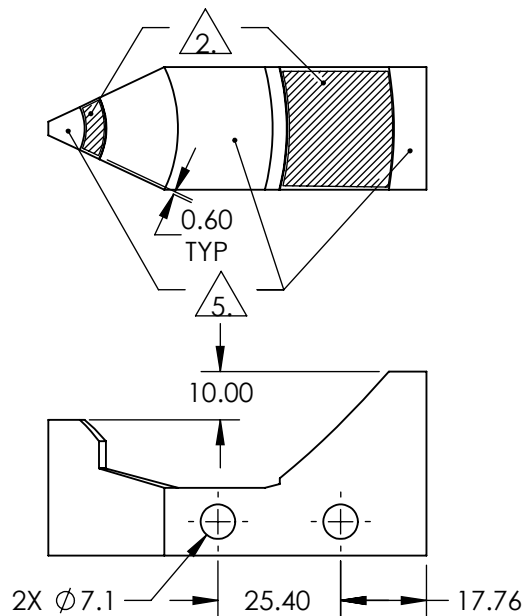
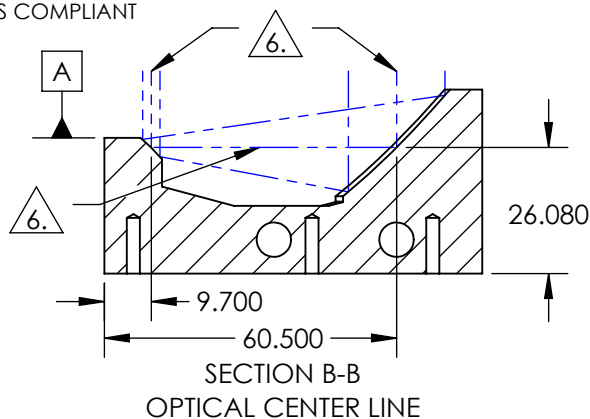

MINOR SCRATCHES ON THE NON-OPTICAL
SURFACE MIGHT BE PRESENT DUE TO THE
MANUFACTURING PROCESS.

**FOR INFORMATION ONLY:
DO NOT MANUFACTURE
PARTS TO THIS DRAWING**

SPECIFICATIONS SUBJECT TO
CHANGE WITHOUT NOTICE
DIMENSIONS ARE FOR
REFERENCE ONLY

Edmund Optics®

SHAPE	S1
BEVEL	MONOLITHIC PROTECTIVE AS NEEDED

THIRD ANGLE PROJECTION	TITLE	5X, Ultrafast Silver Canopus Reflective Beam Expander	SHEET 1 OF 1
ALL DIMS IN	DWG NO	37192	