

NOTES:

1. SUBSTRATE
2. SURFACE S2 TO BE PARALLEL WITH SURFACE S1 TO WITHIN 5 arcsec
3. COATING (APPLY ACROSS COATING APERTURE)
PERFORMANCE SPECIFICATIONS:
T(avg): >85% FROM 400 - 630nm FOR RANDOM POLARIZATION @ 45° AOI
T(abs): >80% FROM 400 - 630nm FOR ALL POLARIZATIONS @ 45° AOI
R(avg): >97% FROM 675 - 850nm FOR RANDOM POLARIZATION @ 45° AOI
R(abs): >95% FROM 675 - 850nm FOR ALL POLARIZATIONS @ 45° AOI
T(abs): = 50% 650nm @ 45° AOI

GDD: $80 \pm 30\text{fs}^2$ @ 420 - 630nm
 $120 \pm 80\text{fs}^2$ @ 400 - 630nm

S1: HARD COATED
 S2: SINGLE LAYER MgF2

4. FINE GRIND SURFACE

5. POWER, IRREGULARITY, AND SURFACE QUALITY SPECIFICATIONS
APPLY ACROSS CLEAR APERTURE
6. TRANSMITTED WAVEFRONT DISTORTION RMS@ 632.8nm $\leq \frac{1}{4} \lambda$
7. ROHS COMPLIANT

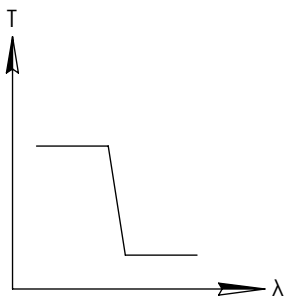

SHORTPASS FILTER

**FOR INFORMATION ONLY:
DO NOT MANUFACTURE
PARTS TO THIS DRAWING**

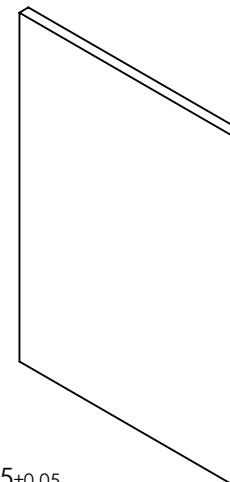
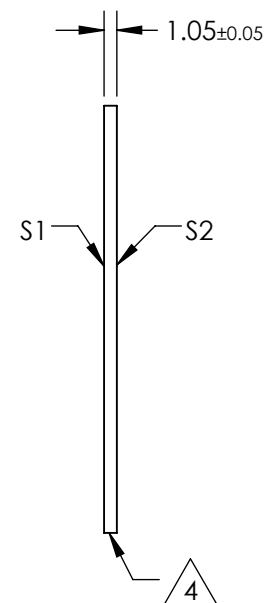
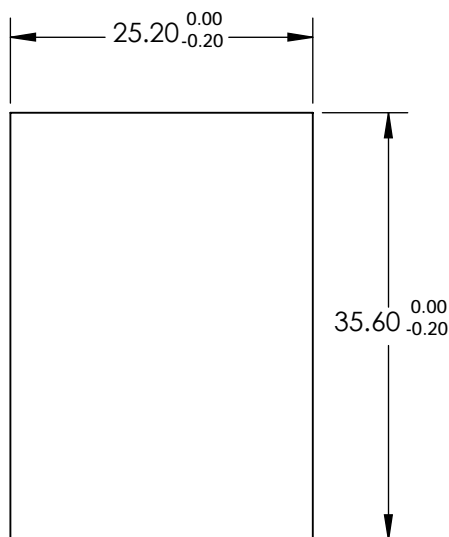

SPECIFICATIONS SUBJECT TO CHANGE WITHOUT NOTICE
 DIMENSIONS ARE FOR REFERENCE ONLY

| | S1 | S2 |
|------------------|----------------------|----------------------|
| SHAPE | PLANO | PLANO |
| SURFACE QUALITY | 40-20 | 40-20 |
| CLEAR APERTURE | 24.2 x 34.6 | 24.2 x 34.6 |
| COATING APERTURE | 24.2 x 34.6 | 24.2 x 34.6 |
| BEVEL | PROTECTIVE AS NEEDED | PROTECTIVE AS NEEDED |

Edmund Optics®

THIRD ANGLE
PROJECTION

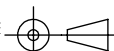

TITLE

650nm, 25.2 x 35.6mm, Low GDD Dichroic
 Shortpass Ultrafast Filter

ALL DIMS IN

mm

DWG NO

14012

SHEET
1 OF 1