

FOR INFORMATION ONLY:  
DO NOT MANUFACTURE  
PARTS TO THIS DRAWING

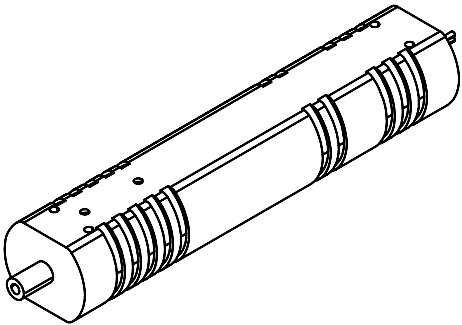
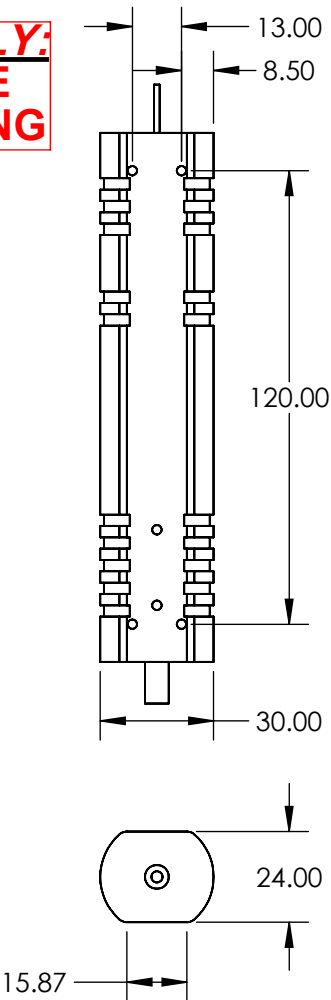

	VALUE
WAVELENGTH (nm)	532
OUTPUT POWER	50
COLOR	GREEN
LASER CLASS	CLASS IIIB
OPERATING TEMPERATURE (°C)	N/A
OPERATING VOLTAGE (V)	+15 to +30
SPATIAL MODE	5.0
LASER TYPE	FIBER-COUPLED
CONNECTOR	DIODE
LENGTH OF FIBER (m)	1

SPECIFICATIONS SUBJECT TO CHANGE WITHOUT NOTICE  
DIMENSIONS ARE FOR REFERENCE ONLY

**EO**® Edmund Optics®

THIRD ANGLE PROJECTION	TITLE	50mW, 532nm Fiber-Coupled Laser Module
ALL DIMS IN	DWG NO	19481
mm		SHEET 1 OF 1