

NOTES:

1. SUBSTRATE:
N-SF6
2. CENTERING TOLERANCE (AT 587.6nm): <2.5ARCMIN
3. COATING (APPLY ACROSS COATING APERTURE)
S1 & S2: V-COAT

4. EDGES: FINE GROUND

5. ASPHERIC FIGURE ERROR: 0.25 μm RMS

6. ASPHERIC SURFACE DESCRIBED BY (REF. COEFFICIENT TABLE):

$$Z_{ASPH}(Y) = \frac{(\frac{Y}{RADIUS})^2 * Y^2}{1 + \sqrt{1 - (1+k) * (\frac{Y}{RADIUS})^2 * Y^2}} + D * Y^2 + E * Y^4 + F * Y^6 + G * Y^8 + H * Y^{10} + J * Y^{12} + L * Y^{14}$$

**FOR INFORMATION ONLY:
DO NOT MANUFACTURE
PARTS TO THIS DRAWING**

SPECIFICATIONS SUBJECT TO CHANGE WITHOUT NOTICE
DIMENSIONS ARE FOR REFERENCE ONLY

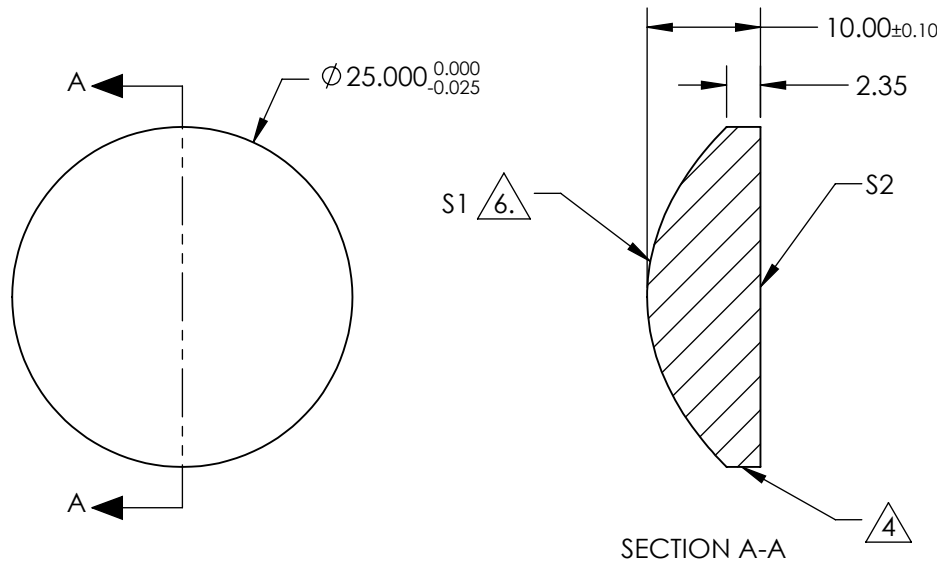

COEFFICIENT TABLE	
COEFFICIENT	
SEMI-DIAMETER	7.500000E+00
(1/RADIUS)	1.165501E-01
k	-1.009000E-00
D	0.000000E+00
E	7.761231E-05
F	-1.512125E-08
G	-1.010535E-09
H	-6.978112E-12
J	4.479090E-14
L	0.000000E+00

	S1	S2
SHAPE	CONVEX	PLANO
SURFACE QUALITY	40 - 20	40 - 20
CLEAR APERTURE	Ø 22.5	Ø 22.5
BEVEL	PROTECTED AS NEEDED	PROTECTED AS NEEDED



ALL DIMS IN

mm

EO® Edmund Optics®

TITLE

25mm Dia., 0.83 NA, V-Coated 1550nm NIR
Aspheric Lens

DWG NO

22938

SHEET
3 OF 5