

NOTES:

1. SUBSTRATE: VACUUM UV GRADE CaF2

2. COATING

S1: NIR II (750-1550nm)  
S2: NIR II (750-1550nm)

3. CENTERING: 1 arcmin

4. RoHS: COMPLIANT

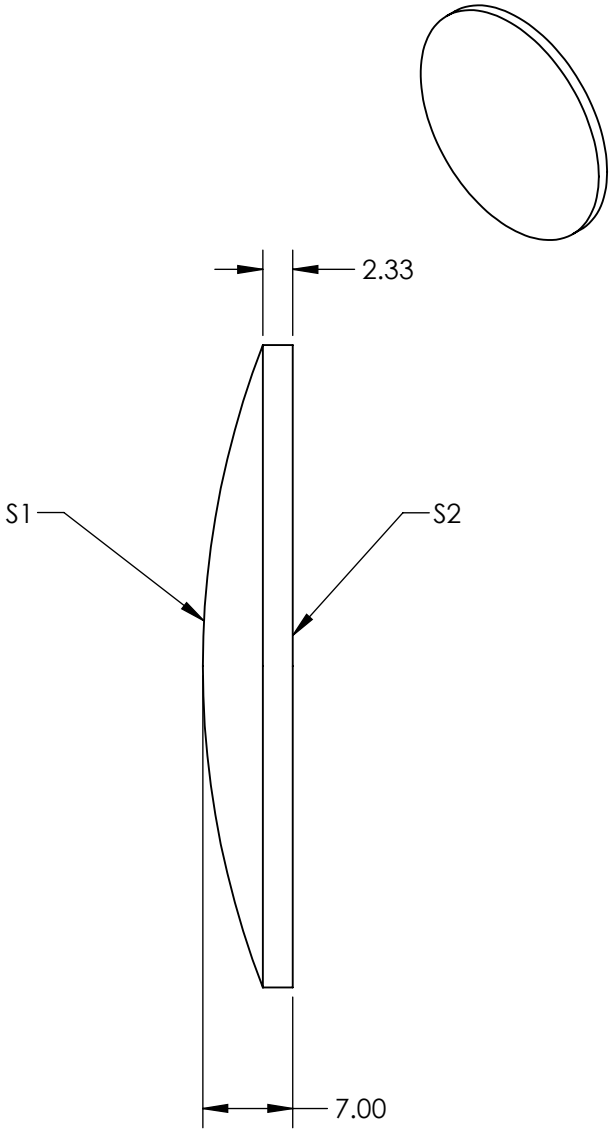
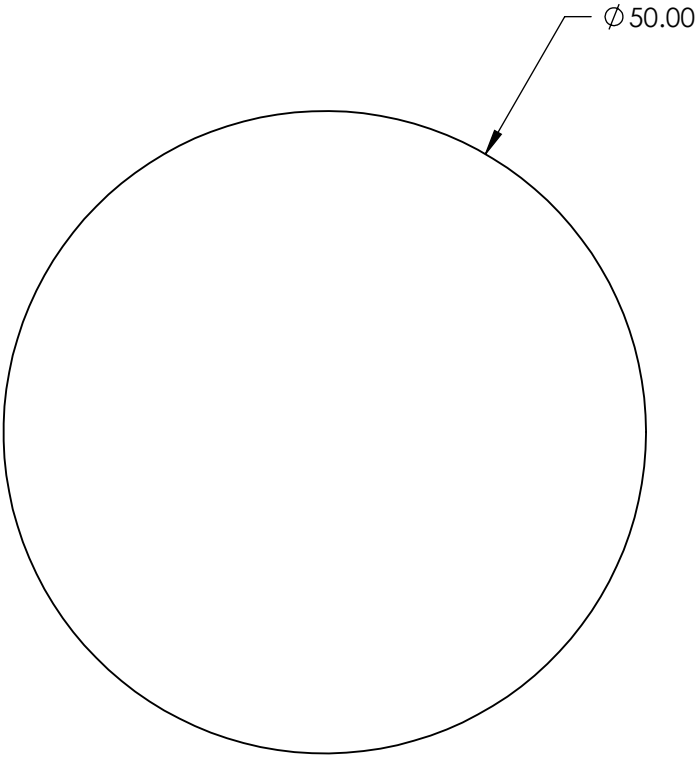

**FOR INFORMATION ONLY:  
DO NOT MANUFACTURE  
PARTS TO THIS DRAWING**

SPECIFICATIONS SUBJECT TO CHANGE WITHOUT NOTICE  
DIMENSIONS ARE FOR REFERENCE ONLY

	S1	S2
SHAPE	CONVEX	PLANO
RADIUS	69.31	INFINITY
SURFACE QUALITY	40-20	40-20
CLEAR APERTURE	Ø 48	Ø 48
BEVEL	PROTECTED AS NEEDED	PROTECTED AS NEEDED

THIRD ANGLE  
PROJECTION

ALL DIMS IN

mm

Edmund Optics®

TITLE

LENS PCX CAF2 50 X 150 NIR II CTD

DWG NO

22534

SHEET  
20 OF 20