

1. SUBSTRATE:  
N-BK7

S1 & S2: NONE

3. FINE GROUND SURFACE

#### 4. POWER, IRREGULARITY, AND SURFACE QUALITY SPECIFICATIONS APPLY ACROSS CLEAR APERTURE

## 5. ROHS COMPLIANT

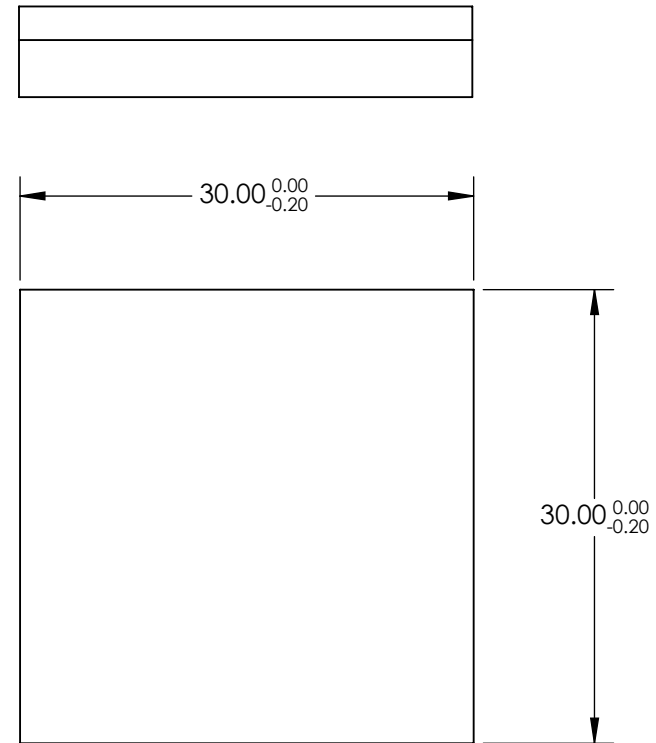
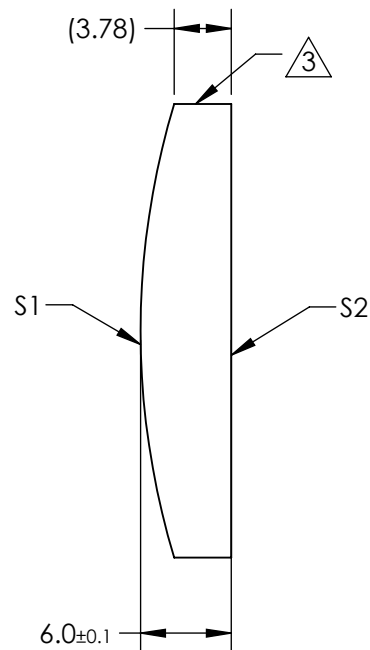

**FOR INFORMATION ONLY:  
DO NOT MANUFACTURE  
PARTS TO THIS DRAWING**

SPECIFICATIONS SUBJECT TO CHANGE WITHOUT NOTICE  
DIMENSIONS ARE FOR REFERENCE ONLY

	S1	S2	EFL	100.00	 Edmund Optics®		
SHAPE	CONVEX	PLANO	BFL	94.04			
RADIUS	51.68	∞	<div>THIRD ANGLE PROJECTION</div> 		TITLE	30mm H x 30mm L x 100mm FL Uncoated, Illumination Grade PCX Cylinder Lens	
SURFACE QUALITY	60 - 40	60 - 40					
CLEAR APERTURE	29.00 x 29.00	29.00 x 29.00	<div>ALL DIMS IN</div> <div>mm</div>		DWG NO	25504	
BEVEL	PROTECTED AS NEEDED	PROTECTED AS NEEDED					
						SHEET 8 OF 8	