

NOTES:

- 1. SUBSTRATE:  
ZERODUR®
- 2. SURFACE S2 TO BE PARALLEL TO SURFACE S1 TO WITHIN 30 ARCSEC
- 3. COATING (APPLY ACROSS CLEAR APERTURE)  
S1: R(abs) >99.8% @ 532nm @ 45° AOI  
R(avg) >99.5% @ 523 - 537nm @ 45° AOI

DAMAGE THRESHOLD, BY DESIGN:  
15 J/cm² @ 532nm, 20ns, 20Hz

S2: NONE

4. FINE GRIND SURFACE

- 5. POWER, IRREGULARITY, AND SURFACE QUALITY SPECIFICATIONS APPLY  
ACROSS CLEAR APERTURE
- 6. CLEAR APERTURE AND COATING APERTURE ARE CENTERED ON SURFACES

**FOR INFORMATION ONLY:  
DO NOT MANUFACTURE  
PARTS TO THIS DRAWING**

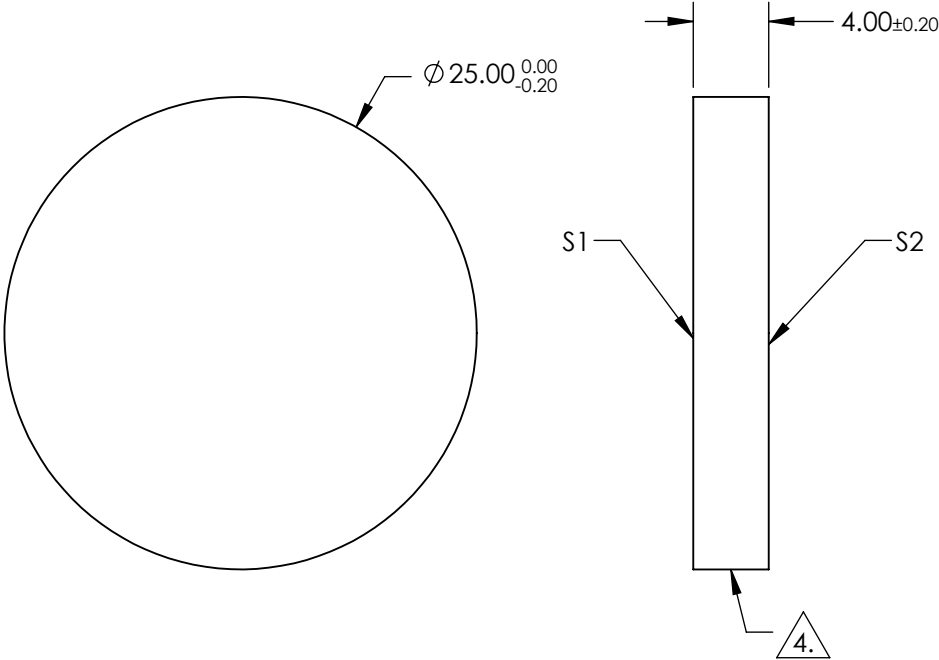

SPECIFICATIONS SUBJECT TO CHANGE WITHOUT NOTICE  
DIMENSIONS ARE FOR REFERENCE ONLY

	S1	S2
SHAPE	PLANO	PLANO
SURFACE QUALITY	20-10	COMMERCIAL POLISH
CLEAR APERTURE	Ø 22.50	N/A
COATING APERTURE	Ø 22.50	N/A
BEVEL	PROTECTED AS NEEDED	PROTECTED AS NEEDED



ALL DIMS IN

mm

**EO**® **Edmund Optics**®

TITLE

25mm Dia. 532nm 45°, Nd:YAG Laser Line  
Mirror

DWG NO

26427

SHEET  
16 OF 86