

- NOTES:
- 1. SUBSTRATE:  
FUSED SILICA (CORNING 7980)
  - 2. S1 TO BE PARALLEL WITH S2 TO WITHIN <1 ARCMIN
  - 3. COATING (APPLY ACROSS CLEAR APERTURE)  
S1 & S2: NIR II (750-1550nm)  
R(ABS) ≤1.5% @ 750 - 800nm  
R(ABS) ≤1.0% @ 800 - 1550nm  
R(AVG) ≤0.7% @ 750 - 1550nm
  - 4. FINE GRIND SURFACE
  - 5. ROHS COMPLIANT

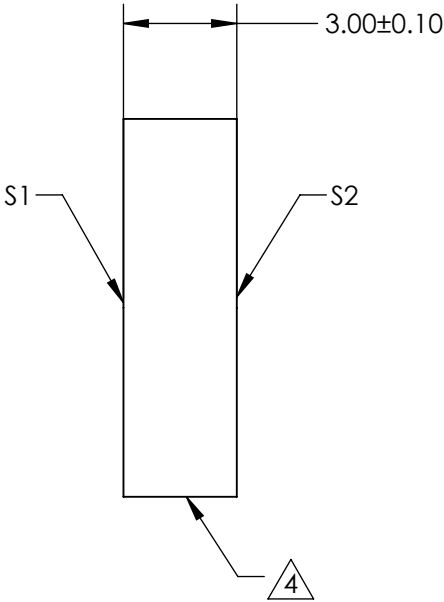
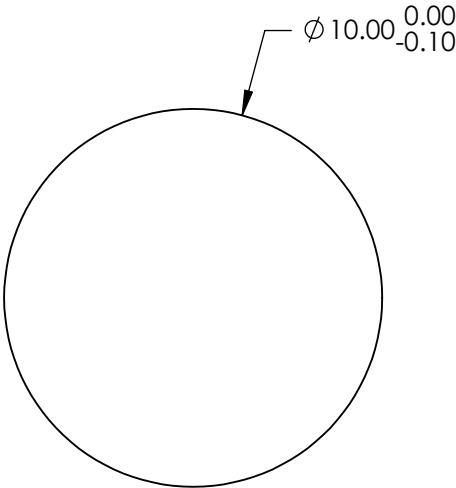
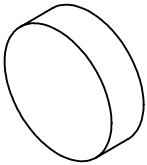

**FOR INFORMATION ONLY:  
DO NOT MANUFACTURE  
PARTS TO THIS DRAWING**

SPECIFICATIONS SUBJECT TO CHANGE WITHOUT NOTICE  
DIMENSIONS ARE FOR REFERENCE ONLY

|                 | S1                  | S2                  |
|-----------------|---------------------|---------------------|
| SHAPE           | PLANO               | PLANO               |
| SURFACE QUALITY | 40 - 20             | 40 - 20             |
| CLEAR APERTURE  | Ø 9.00              | Ø 9.00              |
| BEVEL           | PROTECTED AS NEEDED | PROTECTED AS NEEDED |

THIRD ANGLE  
PROJECTION

ALL DIMS IN      mm

 **Edmund Optics®**

|        |   |                  |
|--------|---|------------------|
| TITLE  | 10mm Dia., 3mm Thick, NIR II Coated, λ/4<br>Fused Silica Window |                  |
| DWG NO | 72339   | SHEET<br>5 OF 84 |