

- NOTES:
- 1. SUBSTRATE:  
FUSED SILICA (CORNING 7980)
  - 2. S1 TO BE PARALLEL WITH S2 TO WITHIN <1 ARCMIN
  - 3. COATING (APPLY ACROSS CLEAR APERTURE)  
S1 & S2: UV-VIS (250-700nm)  
R(ABS) ≤1.0% @ 350 - 450nm  
R(AVG) ≤1.5% @ 250 - 700nm

4. FINE GRIND SURFACE

5. ROHS COMPLIANT

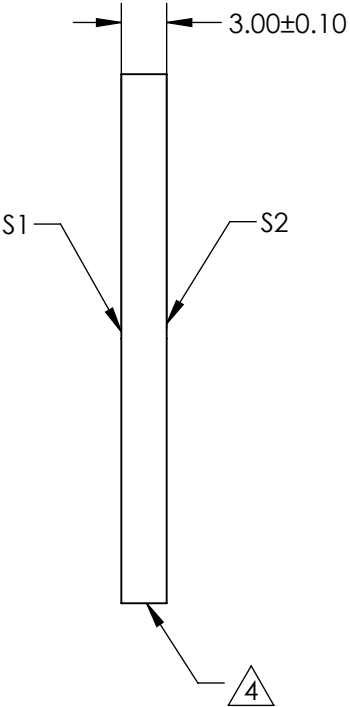
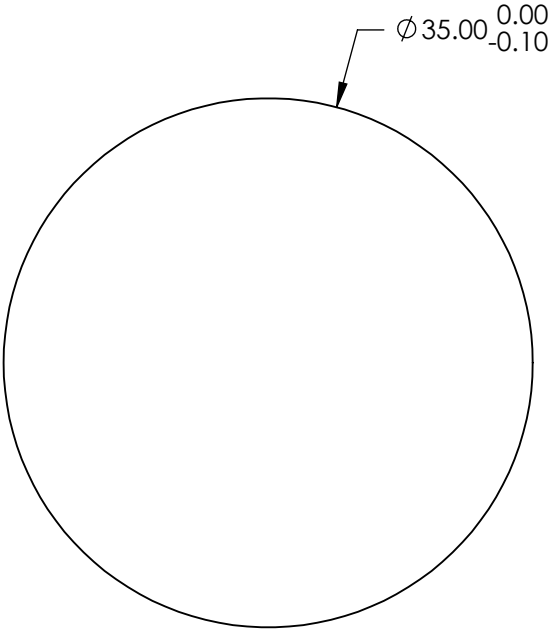

**FOR INFORMATION ONLY:  
DO NOT MANUFACTURE  
PARTS TO THIS DRAWING**

SPECIFICATIONS SUBJECT TO CHANGE WITHOUT NOTICE  
DIMENSIONS ARE FOR REFERENCE ONLY

	S1	S2
SHAPE	PLANO	PLANO
SURFACE QUALITY	40 - 20	40 - 20
CLEAR APERTURE	$\varnothing 31.50$	$\varnothing 31.50$
BEVEL	PROTECTED AS NEEDED	PROTECTED AS NEEDED

THIRD ANGLE  
PROJECTION

ALL DIMS IN      mm

**EO**® Edmund Optics®

TITLE      35mm Dia., 3mm Thick, UV-VIS Coated,  $\lambda/4$   
Fused Silica Window

DWG NO      72390

SHEET  
50 OF 84