

- NOTES:
- 1. SUBSTRATE:
FUSED SILICA (CORNING 7980)
 - 2. S1 TO BE PARALLEL WITH S2 TO WITHIN <1 ARCMIN
 - 3. COATING (APPLY ACROSS CLEAR APERTURE)
S1 & S2: VIS 0° (425-675nm)
R(AVG) ≤0.4% @ 425 - 675nm

4. FINE GRIND SURFACE
5. ROHS COMPLIANT

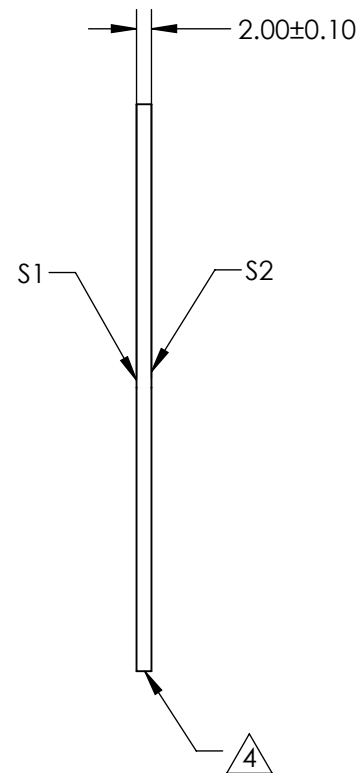
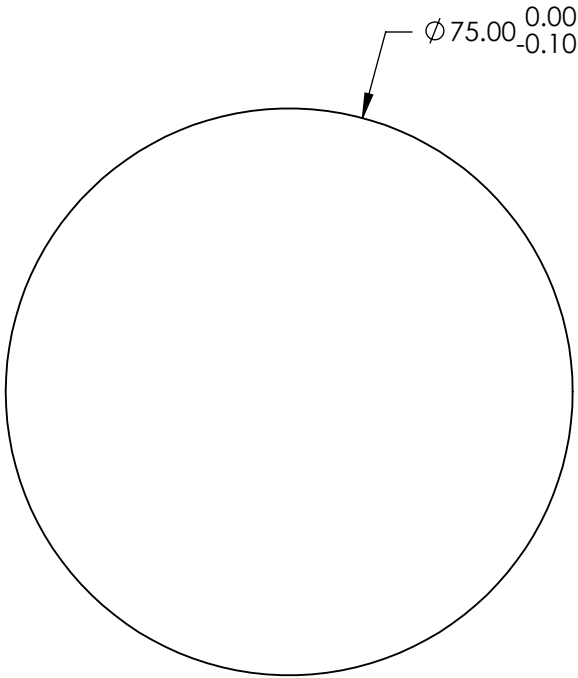

FOR INFORMATION ONLY:
DO NOT MANUFACTURE
PARTS TO THIS DRAWING

SPECIFICATIONS SUBJECT TO CHANGE WITHOUT NOTICE
DIMENSIONS ARE FOR REFERENCE ONLY

	S1	S2
SHAPE	PLANO	PLANO
SURFACE QUALITY	40 - 20	40 - 20
CLEAR APERTURE	$\phi 67.50$	$\phi 67.50$
BEVEL	PROTECTED AS NEEDED	PROTECTED AS NEEDED

THIRD ANGLE
PROJECTION

ALL DIMS IN mm

EO® **Edmund Optics**®

TITLE 75mm Dia., 2mm Thick, VIS 0° Coated, $\lambda/4$
Fused Silica Window

DWG NO 72422