

NOTES:

- 1. SUBSTRATE:  
FUSED SILICA (CORNING 7980)
- 2. S1 TO BE PARALLEL WITH S2 TO WITHIN <1 ARCMIN
- 3. COATING (APPLY ACROSS CLEAR APERTURE)  
S1 & S2: NIR II (750-1550nm)  
R(ABS) ≤1.5% @ 750 - 800nm  
R(ABS) ≤1.0% @ 800 - 1550nm  
R(AVG) ≤0.7% @ 750 - 1550nm
- 4. FINE GRIND SURFACE
- 5. ROHS COMPLIANT

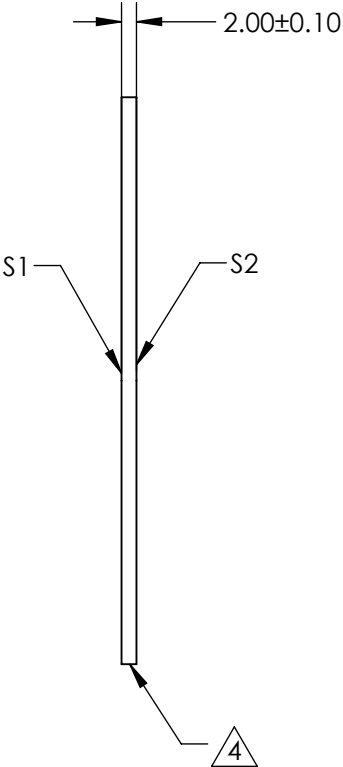
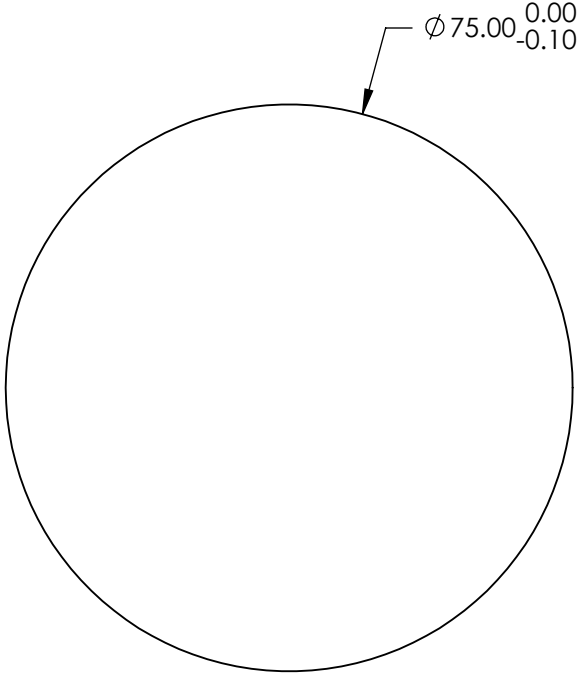

**FOR INFORMATION ONLY:  
DO NOT MANUFACTURE  
PARTS TO THIS DRAWING**

SPECIFICATIONS SUBJECT TO CHANGE WITHOUT NOTICE  
DIMENSIONS ARE FOR REFERENCE ONLY

|                 | S1                  | S2                  |
|-----------------|---------------------|---------------------|
| SHAPE           | PLANO               | PLANO               |
| SURFACE QUALITY | 40 - 20             | 40 - 20             |
| CLEAR APERTURE  | $\phi 67.50$        | $\phi 67.50$        |
| BEVEL           | PROTECTED AS NEEDED | PROTECTED AS NEEDED |

THIRD ANGLE  
PROJECTION

ALL DIMS IN mm

Edmund Optics®

|        |  |                |
|--------|--|----------------|
| TITLE  | 75mm Dia., 2mm Thick, NIR II Coated, $\lambda/4$ Fused Silica Window |                |
| DWG NO | 72424  | SHEET 83 OF 84 |