

[All Products](#) / [Optics](#) / [Prisms](#) / [Mounted N-BK7 Corner Cube Retroreflectors](#)

[See all 13 Products in Family](#)

TECHSPEC® 50.8mm



Mounted N-BK7 Corner Cube Retroreflectors

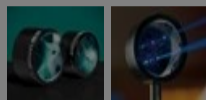

Please select your shipping country to view the most accurate inventory information, and to determine the correct Edmund Optics sales office for your order.

Select Your Country/Region: European Union

Submit

1

€600⁰⁰

ADD TO CART

Volume Pricing

Qty 1-5 €600,00 each

Qty 6-25 €481,00 each

Qty 26-99 €451,00 each

Need More? [Request Quote](#)

Prices shown are exclusive of VAT/local taxes

Product Downloads

- STEP:step
- Curve:pdf
- PDF Drawing:pdf
- IGES:igs
- eDrawing:eprt
- EO Spec Sheet
- [Download All](#)

General

Type: Retroreflector

Physical & Mechanical Properties

Inner Diameter (mm): 50.80 +0.0/-0.1

Outer Diameter (mm): 63.50

Housing Tolerance (mm): Outer Diameter: +0/-0.5, Height: ±0.25

Optical Properties

Beam Deviation (arcsec): ±3

Coating: Silver with protective overcoat

Substrate: [N-BK7](#)

Surface Quality: 60-40

Image Orientation: Left-Handed

Coating Specification: Reflective Surfaces: R_{abs} > 97% FROM 400 - 2500nm @ 0° AOI R_{avg} > 98% FROM 400 - 2500nm @ 0° AOI

Ray Deviation (°): 180

Wavelength Range (nm): 400 - 2500

Power (fringes) @ 632.8nm: 0.25

Irregularity (fringes) @ 632.8nm: 0.25

Threading & Mounting

Mounting Threads: (2) ¼-20 Tapped Holes

Regulatory Compliance

RoHS 2015: Not Compliant

Please select your shipping country to view the most accurate inventory information, and to determine the correct Edmund Optics sales office for your order.

Select Your Country/Region:

Need different specs or modifications?

Edmund Optics offers comprehensive custom manufacturing services for optical and imaging components tailored to your specific application requirements. Whether in the prototyping phase or preparing for full-scale production, we provide flexible solutions to meet your needs. Our experienced engineers are here to assist—from concept to completion.

Our capabilities include:

- Custom dimensions, materials, coatings, and more
- High-precision surface quality and flatness
- Tight tolerances and complex geometries
- Scalable production—from prototype to volume

Learn more about our [custom manufacturing capabilities](#) or submit an inquiry [here](#).

Product Details

- Incident Light is Reflected Back to the Source
- Useful for Surveying and Alignment
- ¼-20 Tapped Holes for Easy Mounting
- Also Available [Unmounted](#)

TECHSPEC® Mounted N-BK7 Corner Cube Retroreflectors are mounted in an aluminum body and held in place with RTV potting cement. Due to their complex shape, corner cube retroreflectors can often be challenging to mount. These retroreflectors provide a convenient and durable solution. TECHSPEC® Mounted N-BK7 Corner Cube Retroreflectors are easily integrated via two ¼-20 tapped holes. In addition, each retroreflector has silvered reflecting surfaces to decrease polarization effects and increase field of view. For dimension details, see the “Technical Information” tab.

Corner cube retroreflectors are designed to reflect any ray or beam entering the prism face, regardless of the prism’s orientation, back onto itself. A mirror will only do that at the normal angle of incidence. As a result, corner cube retroreflectors are ideal where precision alignment is difficult or time-consuming.

LASER OPTICS MADE BY EDMUND OPTICS®

[LEARN MORE](#)

Technical Information

Stock No.	Inner Diameter ID	Outer Diameter OD	H	X
#49-079	7.16	25.40	7.92	14.27
#45-203	12.7	31.75	11.73	18.08
#12-216	12.7	31.75	11.73	18.08
#12-671	12.7	31.75	11.73	18.08
#45-188	25.4	38.10	20.62	26.98
#12-217	25.4	38.10	20.62	26.98
#12-672	25.4	38.10	20.62	26.98
#45-190	38.1	50.80	31.06	37.41
#45-192	50.8	63.50	39.95	46.30
#49-080	63.5	76.20	49.83	56.18
#49-081	76.2	88.90	58.72	65.07

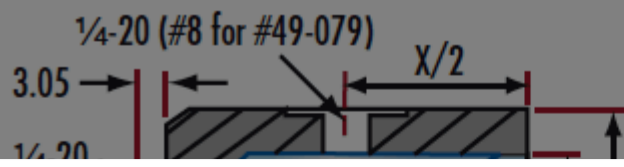

Please select your shipping country to view the most accurate inventory information, and to determine the correct Edmund Optics sales office for your order.

Select Your Country/Region:

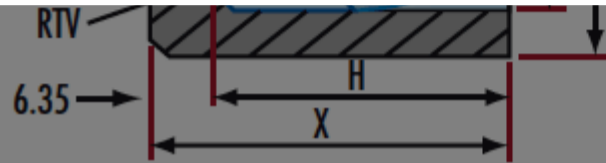

Units: mm

Frequently Purchased Together



#03-669 - 7.0 - 67.0 Optic Height, English Bar-Type Optic Holder
€116,00

Qty



#03-676 - 7.0 - 40.0 Optic Height, English Bar-Type Optic Holder
€106,00

Qty

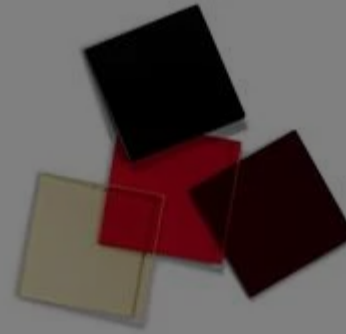

#32-760 - SCHOTT RG-1000, 25.4mm Dia., 3mm Thick, Colored Glass Longpass Filter
€46,00

Qty



#33-978 - Basler ace acA1300-200um Monochrome USB 3.0 Camera
€510,00

Qty

Resources

Media Type

- Application Note
- Video
- FAQ
- Glossary

APPLICATION NOTE

Anti-Reflection (AR) Coatings

APPLICATION NOTE

An Introduction to Optical Coatings

VIDEO

Optical Prisms Review

? FAQ

I'd like to adhere two prisms together. ho...

GLOSSARY

Dove Prism

GLOSSARY

Equilateral (Dispersing) Prism

[View More](#)

Please select your shipping country to view the most accurate inventory information, and to determine the correct Edmund Optics sales office for your order.

Select Your Country/Region: